

SETUP INSTRUCTIONS



PACKING LIST



Ⓐ 1x CEILING



Ⓑ 2x DIVIDER LEFT - RIGHT



Ⓒ 2x DIVIDER FRONT - BACK

TAKE IT



BILLY-JOE DOUBLE BELL
Ceiling + divider liner

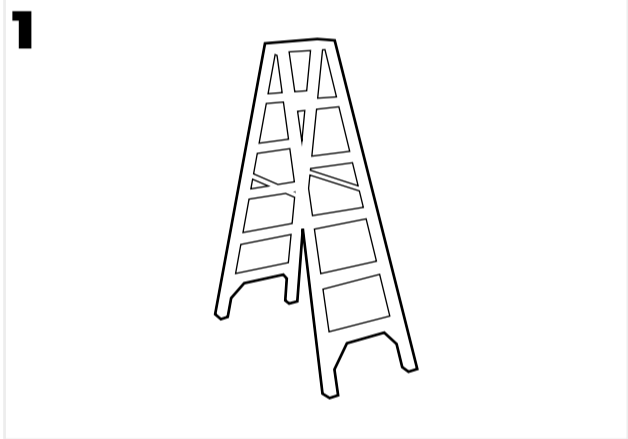
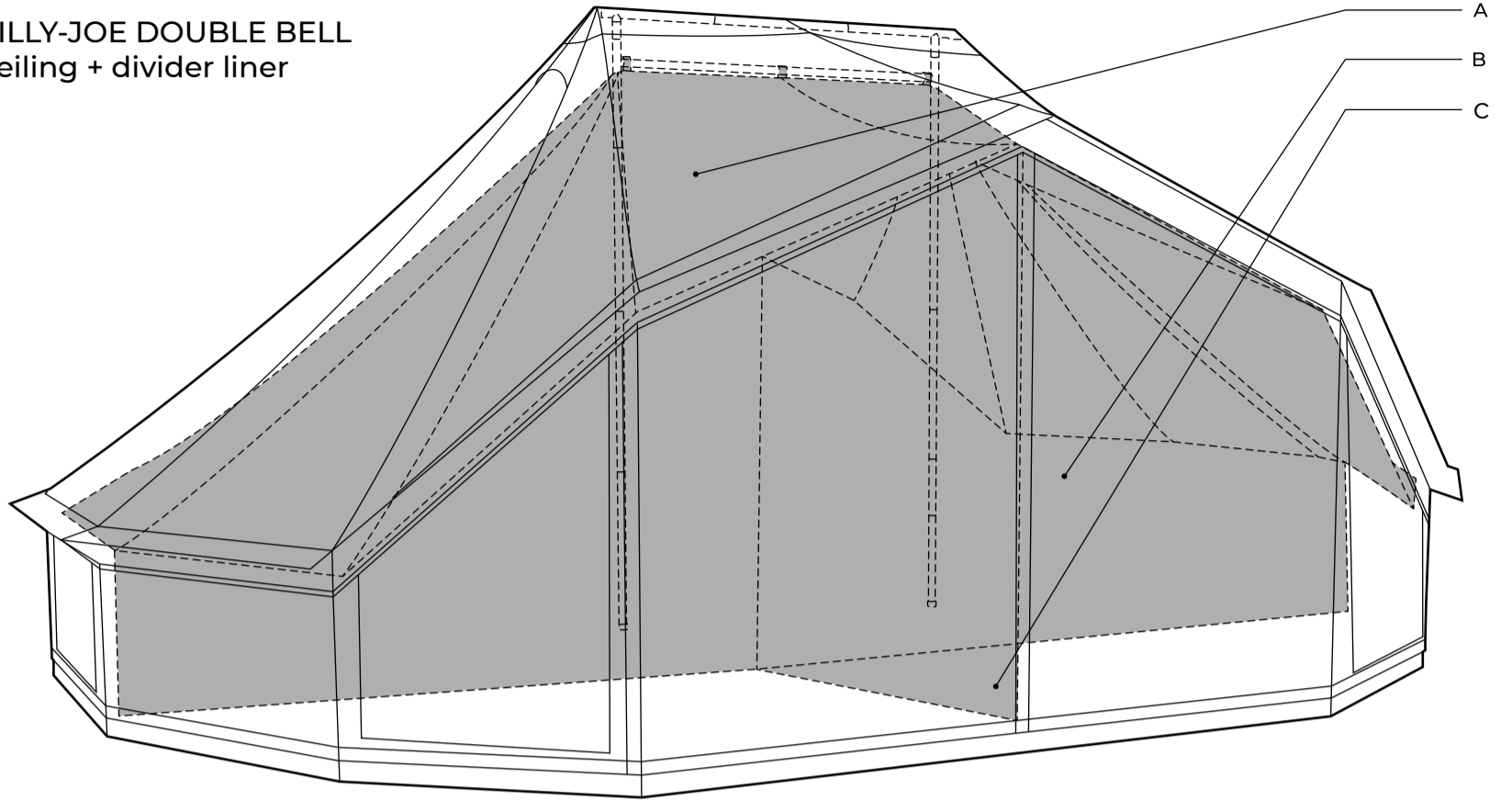

Take your ladder.

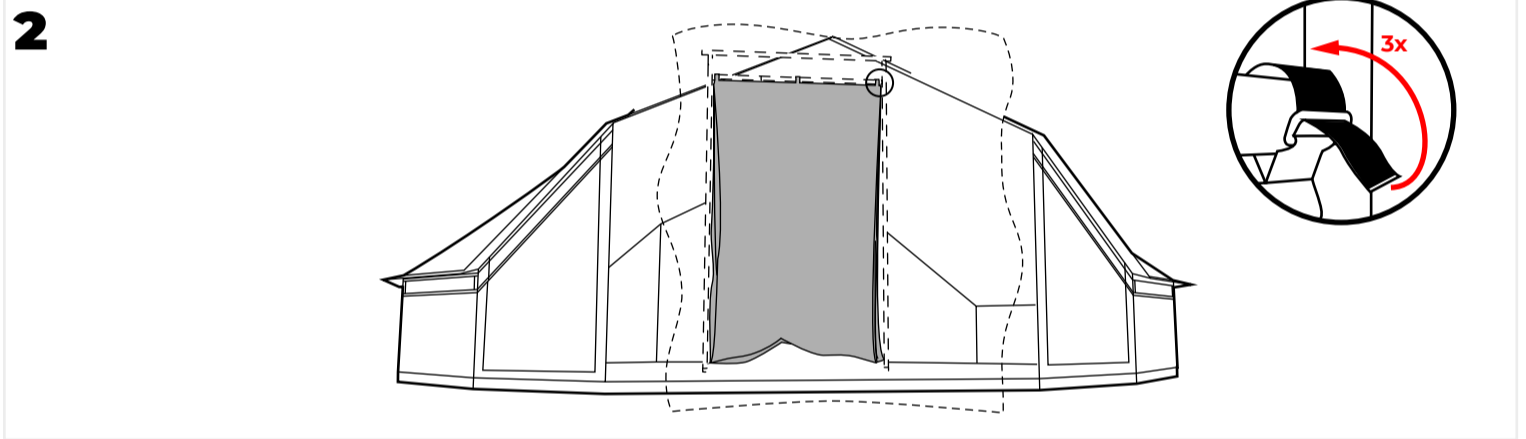

Take your ladder to attach the velcro bands to the lower horizontal bar.

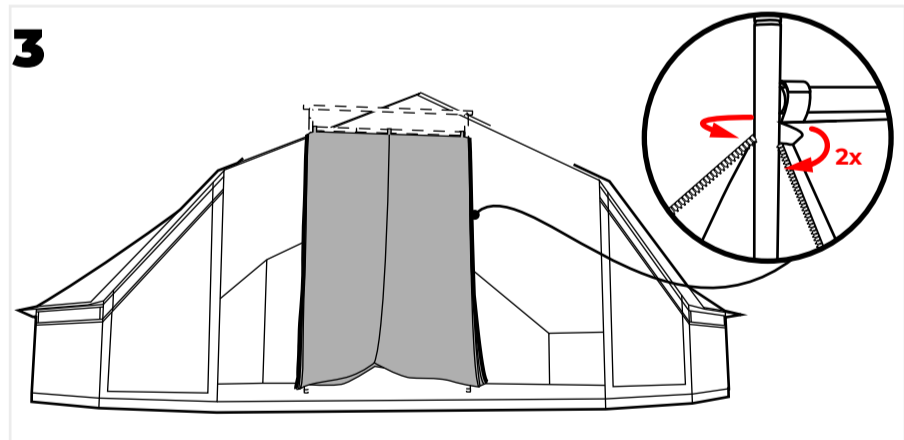

Open the zippers and wrap the ceiling around the center poles.

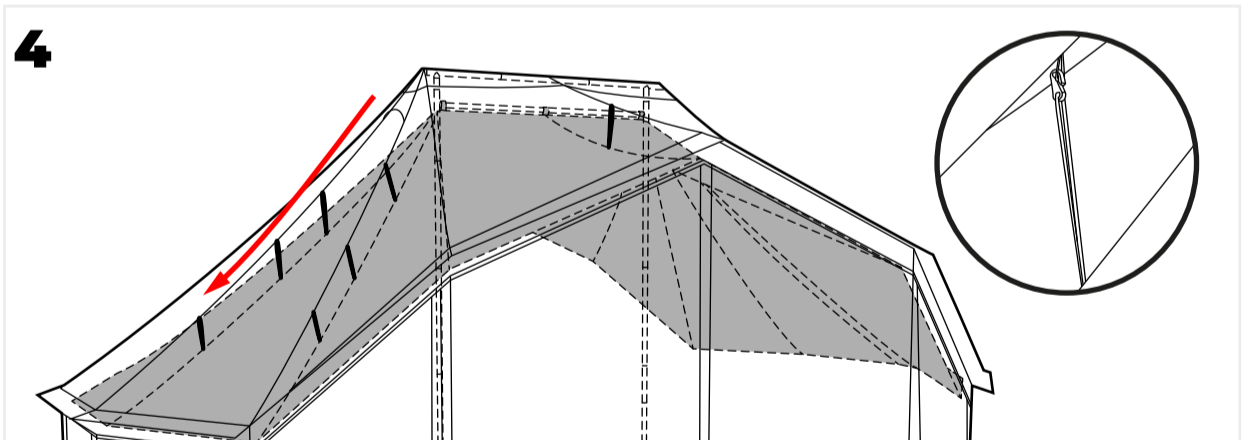

Attach all hooks of the liner into the loops from the roof.

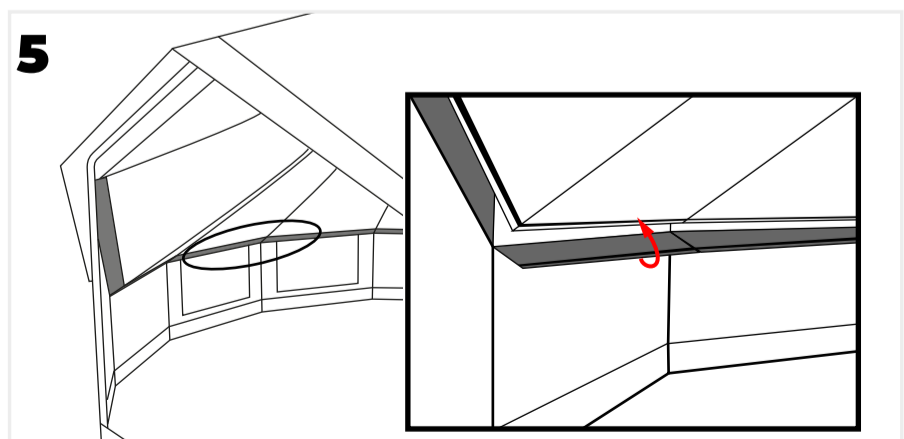

OPTION: Place other velcos around the ventilation of ceiling

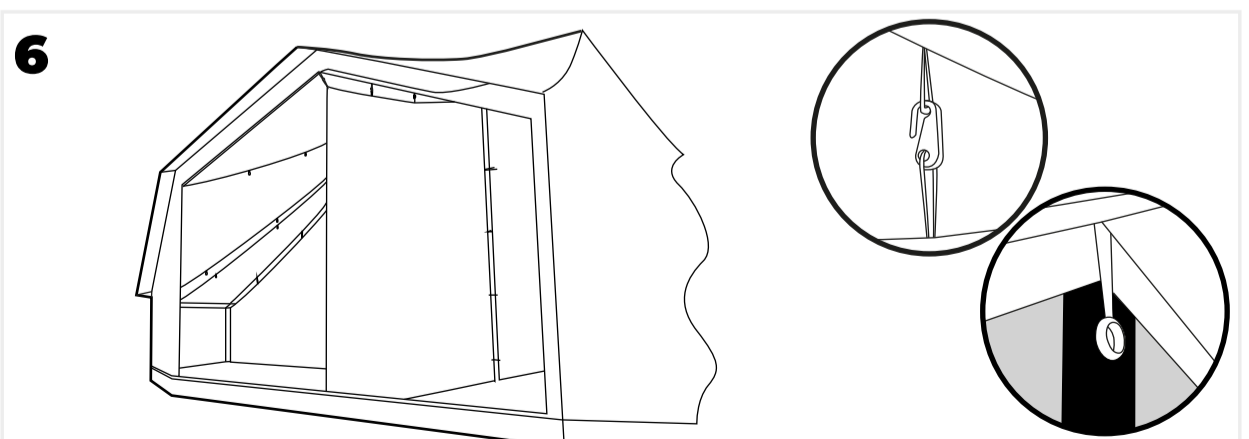

OPTION: Attach the divider to the ceiling.